

THIS DOCUMENT IS SUBJECT TO CHANGE WITHOUT NOTICE. IT IS CONFIDENTIAL AND A PROPERTY OF AMPHENOL LTW. DISCLOSURE TO THIRD PARTY HAS TO BE AUTHORIZED BY AMPHENOL LTW.

REV.	ECN NO.	DATE	SIGN	DESCRIPTION

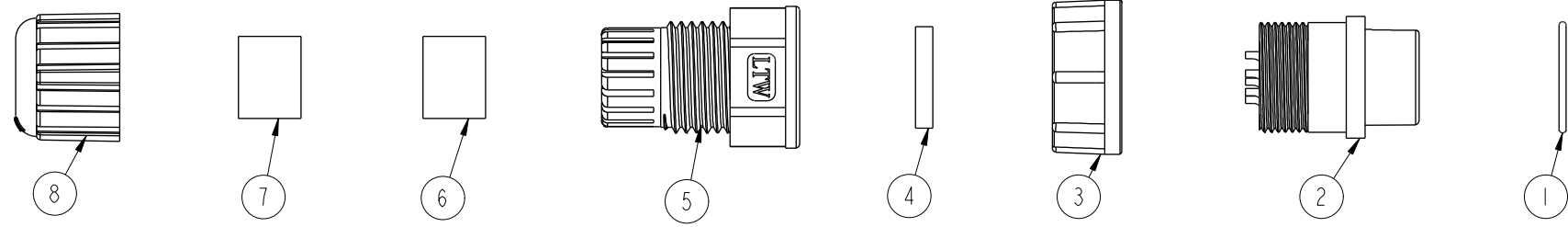

ALTW
CONFIDENTIAL
 2012-04-11
R&D DEPT.

ALTW
DCC. DEPT.
CONFIDENTIAL
 2012-05-21
ISSUED

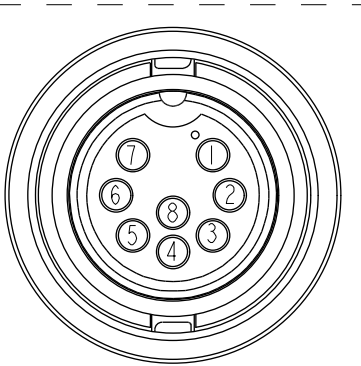
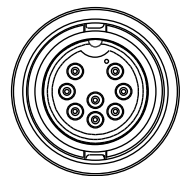
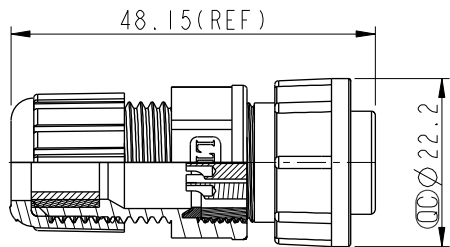

Pin Assignments
Front View

Notes:

- * (CC) Important Dimensions To Check.
- * Waterproof Rate: IP67
- * Housing: Nylon+GF, Black
- * Male Pin: Copper Alloy, Gold Plated
- * O-Ring: EPDM, Black
- * Lock Nut: Nylon+GF, Black
- * Gasket: EPDM, Black
- * Clamp Ring: Nylon, Black
- * Sealing Nut: Nylon, Black
- * Seals B1 for Cable OD: $\varnothing 7.6\text{mm} \sim \varnothing 9.6\text{mm}$
- * Seals B2 for Cable OD: $\varnothing 4.0\text{mm} \sim \varnothing 7.6\text{mm}$
- * One Set Unassembled in One PE Bag.

UNIT:mm TOLERANCE .X ±0.25 .XX ±0.1 .XXX ±0.05 ANGLES ±1°	TITLE Middle, Assy Lock 8Pin F Conn M Pin			<h1 style="text-align: center;">Amphenol LTW</h1> <p style="text-align: center;">安費諾亮泰企業股份有限公司</p>		ITEM NO	CD-08BFMA-LL7001	DRAWN BY	SamChang	DATE	2012-04-11					
	SCALE	1:1	SIZE			A4	SHEET	1	OF	1	DWG NO	CD-08BFMA-LL7001	CHECKED BY	Jeffrey	DATE	2012-05-21
	REV.	A	WC-REV.			A.2	(CC): Inspection item		CUSTOMER	ALTW	APPROVED BY	Lion	DATE	2012-05-21		

A B C D E F